



# The Roberts ORPHEUM THEATER

416 North 9<sup>th</sup> Street St. Louis, MO 63101 (314) 588-0388 (314) 588-9828 FAX

The Roberts Orpheum Theater (formerly The American Theater) is a wonderfully restored, historic theater in downtown St. Louis. It's a versatile facility that is used for both private events and live entertainment.

The house capacity of the theater is 1,456:

Orchestra level.....	502
Mezzanine level .....	621
Including 24 seats in six private boxes	
Balcony level .....	333
Including 56 seats in fourteen private boxes	

The theater is situated in the heart of the revitalized Old Post Office Square district. Within steps of **America's Center** (the St. Louis convention center) & **The Edward Jones Dome** (home of the St. Louis Rams football franchise), and close to two Metrolink (light rail) stops, as well as the **Washington Avenue strip** and **Laclede's Landing** (both areas with a concentration of restaurants, bars, and nightlife). There are many excellent and varied restaurant choices in the vicinity, and more eateries and clubs are continually opening in this vibrant section of the city. The President Casino and The Casino Queen (both with casino gaming, regularly scheduled entertainment, and several restaurant options) are nearby as well.

The venue is bordered by two first class hotels: **The Roberts Mayfair**, a premiere boutique hotel and sister property of the theater; and **The Renaissance Grand**. Also, **The Renaissance Suites** (sister property of The Renaissance Grand) is within one block.

Parking is convenient. For automobiles, the **9<sup>th</sup> Street Garage** is directly across from the front door of the theater, and street parking, as well as other surface and garage options, are within a few blocks. For busses, trucks, and trailers we can assist in arranging secure limited parking immediately next to the theater and additional space within several blocks.

Attached is some basic information, including:

- A map and driving directions
- Local information (area info, hotels, restaurants, etc.)
- A technical advance sheet
- A permanent house equipment inventory sheet
- A stage house diagram
- A brief history of St. Louis' Orpheum Theater
- A house diagram

## THE ROBERTS ORPHEUM THEATER: MAP AND DRIVING DIRECTIONS



### From I-44 east, I-55 north, or I-64 west (from II)

Take Memorial Dr. exit (from I-55 north or I-64 west)  
Continue on Memorial Dr. 0.5 miles (stay in right lane)  
Turn left on Washington Avenue  
Turn left on 8<sup>th</sup> Street (5 blocks)

See “**Remaining instructions from 8<sup>th</sup> Street**”

### Remaining instructions from 8<sup>th</sup> Street

Turn right on Locust (2 blocks)  
Turn right on 9<sup>th</sup> Street (1 block)  
The Roberts Orpheum Theater is halfway  
down the block on the right side of the street

### From I-64 east

Take the 11<sup>th</sup> Street exit (a left exit from the highway)  
Continue on 11<sup>th</sup> Street 10 blocks to Washington Ave.  
Turn right on Washington Avenue  
Turn right on 8<sup>th</sup> Street (3 blocks)

See “**Remaining instructions from 8<sup>th</sup> Street**”

### From I-70 south

Take the North Broadway exit  
Continue heading south on North Broadway 0.5 miles  
Turn right on Washington Avenue  
Turn left on 8<sup>th</sup> Street (3 blocks)

See “**Remaining instructions from 8<sup>th</sup> Street**”

### Parking

The 9<sup>th</sup> Street Garage is directly across the street from theater  
The Convention Center Garage is at the corner of Washington and 8<sup>th</sup> Street (approximately 2 blocks from theater)  
A surface lot is at the corner of Locust and 8<sup>th</sup> Street (approximately 1 block from theater)  
Limited metered street parking can be found nearby

## THE ROBERTS ORPHEUM THEATER: LOCAL INFORMATION

### About St. Louis:

- St. Louis is in the central time zone, and observes national daylight savings time changes.
- The correct pronunciations are “mī-z -r ”and “l- -noi” (there will be a quiz later).
- St. Louis has begun implementing a light rail system (called MetroLink). Currently it goes between Lambert Airport, Forest Park, The Central West End, The U-City/Delmar loop, downtown (with many convenient stops), and Illinois (referred to as “The East Side”). There are two stops near the theater.
- The primary airport is Lambert International (about 15 miles from downtown on I-70, and directly served from downtown by Metrolink). There are 2 main charter airports (The Downtown St. Louis Airport just over the Mississippi River in Illinois, and The Spirit of St. Louis Airport in Chesterfield, a western suburb.) A new additional commercial airport, Mid-America Airport, was built about 30 miles east of downtown in Mascoutah, IL, but has not yet started regularly scheduled service.
- The most common local area code is 314. Area code 636 is found in the outlying western suburbs and in St. Charles county (west of St. Louis county). Area code 618 is found in Illinois.

**Please note:** The following is for informational purposes. The Roberts Orpheum Theater does not specifically endorse any of these establishments (except **The Roberts Mayfair Hotel and The Roberts Mayfair Restaurant, which are both excellent**). Any omissions of area businesses that should be listed are unintentional and will be corrected when brought to our attention.

### Hotels

#### Within 5 blocks of The Roberts Orpheum Theater:

<b>The Roberts Mayfair Hotel, 806 St. Charles Street, <a href="http://www.Wyndham.com">www.Wyndham.com</a> .....</b>	<b>314-421-2500</b>
Drury Inn & Suites, Conv. Center, 711 N. Broadway, <a href="http://www.DruryHotel.com">www.DruryHotel.com</a> .....	314-231-8100
Econo Lodge, Downtown, 1100 N. 3 <sup>rd</sup> Street, <a href="http://www.HotelChoice.com">www.HotelChoice.com</a> .....	314-421-6556
Holiday Inn Select, Convention Center, 811 N. 9 <sup>th</sup> Street, <a href="http://www.HISelect.com">www.HISelect.com</a> .....	314-421-4000
The Renaissance Grand, 806 Wash. Ave., <a href="http://www.RenaissanceHotels.com">www.RenaissanceHotels.com</a> .....	314-621-9600
The Renaissance Suites, 827 Wash. Ave., <a href="http://www.RenaissanceHotels.com">www.RenaissanceHotels.com</a> .....	314-621-9700
WS Hotel & Spa, 400 Washington Avenue, <a href="http://www.WSHotels.com">www.WSHotels.com</a> .....	314-231-1100

#### Within the immediate downtown area:

The Adams Mark, 4th Street and Chestnut, <a href="http://www.AdamsMark.com">www.AdamsMark.com</a> .....	314-241-7400
Courtyard by Marriott, 2340 Market St., <a href="http://www.Marriott.com/stlch">www.Marriott.com/stlch</a> .....	314-241-9111
The Drury Inn, Union Station, 201 S. 20th Street, <a href="http://www.DruryHotel.com">www.DruryHotel.com</a> .....	314-231-3900
The Drury Plaza, 4th Street and Market Street, <a href="http://www.DruryHotel.com">www.DruryHotel.com</a> .....	314-231-3003
The Embassy Suites Hotel, 901 N. 1st Street, <a href="http://www.EmbassySuites.com">www.EmbassySuites.com</a> .....	314-241-4200
Hampton Inn Gateway Arch, 333 Wash. Ave., <a href="http://www.HamptonInnStLouis.com">www.HamptonInnStLouis.com</a> .....	314-621-7900
Hampton Inn, Union Station, 2211 Market Street, <a href="http://www.Hampton-Inns.com">www.Hampton-Inns.com</a> .....	314-241-3200
The Hyatt Regency, #1 St. Louis Union Station, <a href="http://www.StLouis.Hyatt.com">www.StLouis.Hyatt.com</a> .....	314-231-1234
Millennium Hotel, 200 S. 4th Street, <a href="http://www.MillenniumHotels.com">www.MillenniumHotels.com</a> .....	314-241-9500
Omni Majestic Hotel, 1019 Pine Street, <a href="http://www.OmniHotels.com">www.OmniHotels.com</a> .....	314-436-2355
Radisson Hotel & Suites, 200 N. 4th Street, <a href="http://www.Radisson.com">www.Radisson.com</a> .....	314-621-8200
Sheraton City Center Hotel, 400 S. 14th Street, <a href="http://www.Sheraton.com">www.Sheraton.com</a> .....	314-231-5007
St. Louis Marriott Pavilion, 1 Broadway, <a href="http://www.Marriott.com">www.Marriott.com</a> .....	314-421-1776
Westin St. Louis, 811 Spruce Street, <a href="http://www.Westin.com/StLouis">www.Westin.com/StLouis</a> .....	314-621-2000

### Restaurants

#### Within 5 blocks of The Roberts Orpheum Theater:

<b>The Roberts Mayfair Restaurant &amp; Bar, 806 St. Charles (upscale) .....</b>	<b>314-421-2500</b>
An American Place, 800 Wash. Ave. (in The Renaissance Grand Hotel, upscale) .	314-621-9600
Breve Espresso Coffee House, 417 N. 10 <sup>th</sup> Street .....	314-231-5282
Charley Gitto's Pasta House, 207 N. 6 <sup>th</sup> Street .....	314-436-2828
Chinese Wok, 1009 Locust Street .....	314-231-4841
Curry in a Hurry, 612 Olive Boulevard .....	314-241-7900

Dooley's Pub, 308 N. 8 <sup>th</sup> Street .....	314-231-4200
Downtown Cantina, 513 Olive Boulevard .....	314-231-5620
Edible Difference Restaurant and Catering, 615 Pine Street .....	314-588-8432
Farrago, 1212 Washington Avenue .....	314-231-2345
Haifa's Greek Deli, 211 N. 9 <sup>th</sup> Street .....	314-421-0917
Hunan Manor Chinese Restaurant, 606 Pine Street .....	314-231-2867
Jack Patrick's Pub, 1000 Olive Street .....	314-436-8879
Kelly's Deli, 1104 Locust .....	314-621-5777
Kitchen K Restaurant and Bar, 1000 Washington Avenue (upscale) .....	314-241-9900
Lucas Park Grill, 1324 Washington Avenue (upscale) .....	314-241-7770
Luigi's Pizza, 901 Pine Street .....	314-436-9010
The Mahogany Grill, 1019 Pine Street (upscale) .....	314-436-2355
Maurizio's Pizza, 1107 Olive Street .....	314-621-1997
McMurphy's Grill, 614 N. 11 <sup>th</sup> Street .....	314-231-3006
Mickey's Restaurant, 1113 Pine Street .....	314-621-8881
Mosaic, 11th & Lucas Streets (upscale) .....	314-621-6001
Papa Fabarre's, 601 Olive Street (in Famous Barr department store) .....	314-444-3116
Red Moon, 1500 St. Charles Street .....	314-436-9700
The St. Louis Bread Company, 116 N. 6 <sup>th</sup> Street .....	314-588-0423
Sakkio Japan, 515 N. 6 <sup>th</sup> Street .....	314-231-2382
Sbarro, 515 N. 6 <sup>th</sup> Street .....	314-621-2700
Swiftys, 200 N. 7 <sup>th</sup> Street .....	314-241-4990
10 <sup>th</sup> Street Italian, 504 N. 10 <sup>th</sup> Street .....	314-241-9988
Thai Express, 727 Olive Street .....	314-621-4086
Two Cents Plain Deli, 1114 Olive Street .....	314-436-1070
Wasabi, 1228 Washington Avenue .....	314-421-3500
Washington Avenue Bistro, 827 Wash. Ave. (in The Renaissance Suites, upscale) .....	314-418-5750

**Within the immediate downtown area:**

Al's Restaurant, 1200 N. 1 <sup>st</sup> Street (upscale) .....	314-421-6399
Caleco's Bar & Grill, 101 N. Broadway (kitchen open very late) .....	314-421-0708
Dierdorf & Hart's Steakhouse, 701 Market Street (upscale) .....	314-421-1772
Harry's Restaurant & Bar, 2144 Market Street (upscale) .....	314-421-6969
J.F. Sanfilippo's Restaurant, 705 N. Broadway .....	314-621-7213
Kemoll's Restaurant, 1 Metropolitan Square (upscale) .....	314-421-0555
Maggie O'Brien's, 2000 Market Street .....	314-421-1388
Max & Erma's Deli & Grill, 316 Market Street .....	314-621-5815
Mike Shannon's Steaks & Seafood, 100 N. 7 <sup>th</sup> Street (upscale) .....	314-421-1540
Red Moon, 15th & St. Charles .....	314-436-9700
Rue 13, 1313 Washington Avenue .....	314-588-9797
The St. Louis Steakhouse, 101 S. 11 <sup>th</sup> Street .....	314-241-1121
The Schlafly Tap Room, 2100 Locust Street .....	314-241-2337
Studio Café, 1313 Washington Avenue .....	314-621-8667
TGI Friday's, 529 Chestnut Street .....	314-241-8443
Tony's Restaurant, 410 Market Street (upscale) .....	314-231-7007

**On Laclede's Landing (approximately 12 - 14 blocks from the theater)**

Fat Tuesday, 700 N. 2 <sup>nd</sup> Street .....	314-241-2008
Hair of the Dog, 720 N. 3 <sup>rd</sup> Street .....	314-621-0271
Hannegan's Restaurant & Pub, 719 N. 2 <sup>nd</sup> Street .....	314-241-8877
Jake's Steaks, 708 N. 2 <sup>nd</sup> Street .....	314-621-8184
Joey B's On The Landing, 710 N. 2 <sup>nd</sup> Street .....	314-621-9570
The Morgan Street Brewery, 721 N. 2 <sup>nd</sup> Street .....	314-231-9970
The Old Spaghetti Factory, 727 N. 1 <sup>st</sup> Street .....	314-621-0276
Show-Me's On The Landing, 724 N. 1 <sup>st</sup> Street .....	314-241-8245
Skeeters Eatery, 727 N. 1 <sup>st</sup> Street .....	314-241-2220
S. Hunan 3, 707 N. 1 <sup>st</sup> Street (Lower Level) .....	314-621-5889
The St. Louis Fish Market, 901 N. 1 <sup>st</sup> Street (upscale) .....	314-621-4612

Subway Sandwiches & Salads, 707 N. 1 <sup>st</sup> Street (Lower Level) .....	314-436-1115
Sundecker's Bar and Grill, 900 N. 1 <sup>st</sup> Street .....	314-241-5915
The Trainwreck On The Landing, 720 N. 1 <sup>st</sup> Street .....	314-436-1006

**At Union Station, 1820 Market Street (approximately one mile from the theater)**

Aldos, 1 <sup>st</sup> Level .....	314-802-6121
All Star Diner, 2 <sup>nd</sup> Level .....	314-588-2455
Golden Dragon, 1 <sup>st</sup> Level .....	314-436-3502
Hooters, 3 <sup>rd</sup> Level .....	314-436-8888
Hard Rock Café, Under the Train Shed .....	314-621-7625
Houlihan's, 1 <sup>st</sup> Level .....	314-436-0844
Key West Café, 1 <sup>st</sup> Level .....	314-241-2566
Krieger's Your Hometown Sports Grill, 1 <sup>st</sup> Level .....	314-436-1692
Landry's Seafood House, Under the Train Shed .....	314-231-4040
Route 66 Brewery & Restaurant, 1 <sup>st</sup> Level .....	314-231-4677
The Station Grille, In the Hyatt Hotel (upscale) .....	314-231-1234

**Nightclubs and Bars**

AJ's at the Adam's Mark, 4 <sup>th</sup> Street and Chestnut .....	314-241-0553
Creepy Crawl, 412 Tucker Avenue .....	314-621-9019
The Kastle, 3207 Washington Avenue .....	314-534-1571

**On the Washington Avenue strip (approximately 6 - 12 blocks from the theater)**

Europe, 1521 Washington Avenue .....	314-421-1521
Farrago, 1212 Washington Avenue .....	314-231-2345
Inferno, 1401 Washington Avenue .....	
Isis, 1204 Washington Avenue .....	314-436-0600
Ritz, 1216 Washington Avenue .....	
Rue 13, 1313 Washington Avenue .....	314-588-9797
Studio Café, 1309 Washington Avenue .....	314-621-8667
Velvet Lounge, 1301 Washington Avenue .....	314-241-8178

**On Laclede's Landing (approximately 12 - 14 blocks from the theater)**

Bar St. Louis, 612 N. 2nd Street .....	314-241-4550
The Big Bang, 807 N. 2nd Street .....	314-241-2264
Club Buca, 707 Clamorgan Alley .....	314-231-2822
Crazy Louie's, 118 Morgan Street .....	314-231-3200
Fat Tuesday, 700 N. 2nd Street .....	314-241-2008
Rum Jungle, 618 N. 2nd Street .....	314-231-5825
Sundecker's Bar and Grill, 900 N. 1st Street .....	314-241-5915
The Trainwreck On The Landing, 720 N. 1st Street .....	314-436-1006

**At Union Station, 1820 Market Street (approximately one mile from the theater)**

Plush, 1st Level .....	314-436-7311
------------------------	--------------

<p><b>NOTE:</b> These are just the establishments in the neighborhood. There are too many sections of town with bars and nightclubs to list here</p>
--

**Other Services**

**Local Ground Transportation**

Allen Cab Company .....	314-241-7722
Amtrak, 550 South 16 <sup>th</sup> Street (behind Union Station) .....	800-872-7245
Best Transportation (limo & sedan service) 9930 Meeks Boulevard .....	314-989-1500
Central States Charter Coach, 2450 Cassens Drive .....	636-343-6050
County Cab Company, 9930 Meeks Boulevard .....	314-991-5544

Destination St. Louis (charter busses & shuttles), 7710 Big Bend Boulevard .....	314-727-2400
GEM Transportation (limo, sedan, & van service), 11774 Missouri Bottom Road ...	314-731-1707
Grayline Bus .....	314-421-4753
Harris & Eagle Cab Company, 3740 Enright Avenue .....	314-535-5087
JED Limousine Services, 9724 St. Charles Rock Road .....	314-429-2200
Laclede Cab Company, 600 South Vandeventer Avenue .....	314-535-1162
Lambert International Airport .....	314-426-8000
Metro (public busses & light rail), 707 North 1 <sup>st</sup> Street, <a href="http://www.Bi-State.org">www.Bi-State.org</a> .....	314-982-1400
Mid-American Coaches .....	314-316-9504
Mound City Yellow Cab Company, 6111 Delmar Boulevard .....	314-361-2345
Tour St. Louis (charter busses & shuttles), 1100 South 6 <sup>th</sup> Street .....	314-241-1400

### **Cleaners and Laundromats**

Band Box Cleaners, 1110 Locust Street .....	314-421-3122
Erlich's 4 Hour Cleaner and Shirt Laundry, 1400 Washington Avenue .....	314-241-8935
Globe Cleaners, 720 North Tucker Boulevard .....	314-241-2322
Personal Service Cleaners, 909 Chestnut Street .....	314-231-3001
St. Louis Center Cleaners, 515 North 6 <sup>th</sup> Street .....	314-436-4353

### **Markets and Grocers**

City Grocers, Olive Boulevard at 10 <sup>th</sup> Street .....	314-621-0010
--	--------------

### **Other**

Heuer Hardware & Keys, 1100 Locust at 10 <sup>th</sup> Street .....	314-436-1116
Kinkos / FedEx, 800 Wash. Ave. (lower level of The Renaissance Grand Hotel) ...	314-621-9738
The UPS Store, 200 North Broadway .....	
US Post Office, 1140 Olive Street .....	800-275-8577

### **Medical Services**

#### **Pharmacies**

The Medicine Shoppe, 415 North Tucker Avenue (they deliver) .....	314-588-0795
Walgreen's, 515 North 6 <sup>th</sup> Street (in City Centre mall) .....	314-231-3636

#### **Hospitals and Urgent Care Facilities**

BJC Hospital Center, Kingshighway and I-64 .....	314-747-3000
BJC Healthcare, 909 North 14 <sup>th</sup> Street .....	314-747-6047
St. Louis ConnectCare, 1717 Biddle Street .....	314-622-3836

#### **Other**

Alliance Therapy Associates, 721 Olive Street, Suite 1313 .....	314-436-2484
Downtown Chiropractic Clinic, 221 North 7 <sup>th</sup> Street .....	314-588-8511
Downtown Clinic of Optometry, 721 Olive Street, Suite 510 .....	314-231-0581
Downtown Dental, 720 Olive Street, Suite 1700 .....	314-241-4232
Erker Optical, 908 Olive Street .....	314-241-9410
Fisher Optical, 705 Olive Street, Suite 605 .....	314-421-1307

**THE ROBERTS ORPHEUM THEATER: TECHNICAL SPECIFICATIONS**

**Stage dimensions**

Proscenium width .....	39 feet	10 inches
Proscenium height.....	30 feet	
Curtain line to back wall .....	29 feet	9 inches
Curtain line to back pipe position .....	27 feet	4 inches
Stage wall to wall.....	85 feet	
Stage right wing (proscenium to side wall).....	24 feet	
Stage left wing (proscenium to side wall).....	21 feet	

**Fly system information**

Hemp system with 51 line sets (5 lines to a set)		
Stage to grid.....	65 feet	
Fly loft floor to grid.....	38 feet	3 inches
Stage to fly loft floor .....	26 feet	9 inches
Distance between fly lofts stage right and stage left .....	52 feet	6 inches

**Lighting information**

Permanent house equipment inventory .....	see inventory sheet
Electrical current available	
400 amp, 3 phase service available floor stage right (cam locks)	
200 amp, 3 phase service available floor stage right (cam locks)	
200 amp, 3 phase service available floor stage left (cam locks)	
200 amp, 3 phase service available floor stage left (cam locks)	
2 hanging positions for truss available in front of curtain line	
Position 1 throw to curtain line .....	15 feet
Position 2 throw to curtain line .....	25 feet
Mezzanine rail - 40 feet of permanent pipe	
Light throw to curtain line .....	40 feet
Projection booth - 2 windows, 15 feet from side to side	
100 amps available in booth for spots	
Light throw to curtain line .....	100 feet

**Sound & projection equipment information**..... see “House Equipment Inventory”

**Dressing room / production office information** ..... see “Additional Space Information”

**Orchestra pit information** ..... TBA

**THE ROBERTS ORPHEUM THEATER: HOUSE EQUIPMENT INVENTORY**

Equipment list to come

**Permanent house lighting equipment inventory**

TBA..... TBA

**Permanent house sound equipment inventory**

TBA..... TBA

**Permanent house projection equipment inventory**

TBA..... TBA

**THE ROBERTS ORPHEUM THEATER: ADDITIONAL SPACE INFORMATION**

**Dressing Rooms & Work Areas**

Stage Level – Stage Right

- DR4- private dressing room, 14' x 14' .....counter top, mirror, restroom (sink & toilet)
- DR5 - private dressing room, 12' x 10' .....counter top, mirror, restroom (sink & toilet)  
[NOTE: DR5 is often used as a production office, and has phone lines and DSL internet connection]

Stage Level – Stage Left

- DR6 - quick change, 12' x 5' .....utility sink

Lower Level

- DR1 - chorus dressing room, 16' x 11' .....counter tops, mirrors, utility sink
- Men's restroom .....2 stalls, 2 urinals, shower, and sink
- Green room, 26' x 36' (open space)
- Laundry room, 8' x 7' (with water and power, no equipment at this time)
- DR2 - chorus dressing room, 11' x 32' .....counter tops, mirrors, sink
- DR3 - chorus dressing room, 18' x 20' .....counter tops, mirrors, sink
- Women's restroom .....4 stalls, shower, and sink

2<sup>nd</sup> Level – Stage Right

- Restroom .....2 stalls

2<sup>nd</sup> Level – Stage Left

- Restroom .....2 stalls
- DR7 - dressing room, 8' x 8' .....counter top, mirror, sink
- DR8 - dressing room, 8' x 7' .....counter top, mirror, sink

3<sup>rd</sup> Level – Stage Right

- DR9 - dressing room, 10' x 10' .....counter top, mirror, sink
- DR10 - dressing room, 9' x 7' .....counter top, mirror, sink
- DR11 - dressing room, 10' x 7' .....counter top, mirror, sink
- DR12 - dressing room, 8' x 10' .....counter top, mirror, sink

3<sup>rd</sup> Level – Stage Left

- DR13 - dressing room, 8' x 8' .....counter top, mirror, sink
- DR14 - dressing room, 8' x 7' .....counter top, mirror, sink
- DR15 - dressing room, 9' x 12' .....counter top, mirror, sink

**Orchestra Pit**

Information to come

## **THE ROBERTS ORPHEUM THEATER: A BRIEF HISTORY**

The Orpheum Theater was constructed at the corner of 9<sup>th</sup> Street and St. Charles in 1917 by St. Louis self-made millionaire Louis A. Cella. The lead architect was Albert Lansburgh, and artist Leo Lentelli was responsible for the ornate sculptures that are still magnificent today. Lansburgh had already designed seven previous theaters for the Orpheum franchise. Lentelli had began working in Rome in the early part of the twentieth century before moving to New York City where his works were commissioned for many projects, including Rockefeller Center.

When it joined the more than two dozen theaters of the national “Orpheum vaudeville circuit” on its Labor Day opening, the \$500,000 “Parisian style” theater was considered an “architectural masterpiece and technological wonder.”

With the end of vaudeville in the mid 1930s, the theater was leased to Warner Brothers as a movie house, and subsequently Loews assumed its management. In the 1960s it underwent a reincarnation as a performance venue and was re-christened The American Theater.

The venue has played host to a vast array of entertainment, including plays, musicals, and concerts. Many of the great names in American theater graced its stage in the, including Alfred Lunt and Lynne Fontanne, Julie Harris, Cary Grant, Eartha Kit, James Whitmore, Eli Wallach, Liv Ullman, John Gielgud, Paul Robeson, Mae West, and Henry Fonda, to name just a few.

In the early 1980s, The American became primarily a venue for special events (corporate events, weddings, and private parties) and occasional rock concerts. Acts such as Pearl Jam (who filmed a video in the theater), Red Hot Chili Peppers, Alicia Keyes, Dave Mathews Band, Tori Amos, and Nelly appeared on stage.

Then, in December, 2003, St. Louisians Mike and Steve Roberts purchased the theater from Charles Cella, grandson of the visionary who built it. They undertook a major rehabilitation of the theater, bringing it back to its former splendor. Reverting to the original name, The Roberts Orpheum Theater returned to full operation to host a wide variety of events including concerts, theater, dance, lectures, and movies, as well as corporate events, conferences, and private parties.

We are honored to be entrusted with the legacy of The Roberts Orpheum Theater and its rich heritage, and are committed to maintaining its status as a first rate venue for generations of St. Louisians to come.

## THE ROBERTS ORPHEUM THEATER: AUDITORIUM LAYOUTS

The diagram on the left shows all three levels “theater style,” the diagram on the right show the Orchestra level “banquet style.”

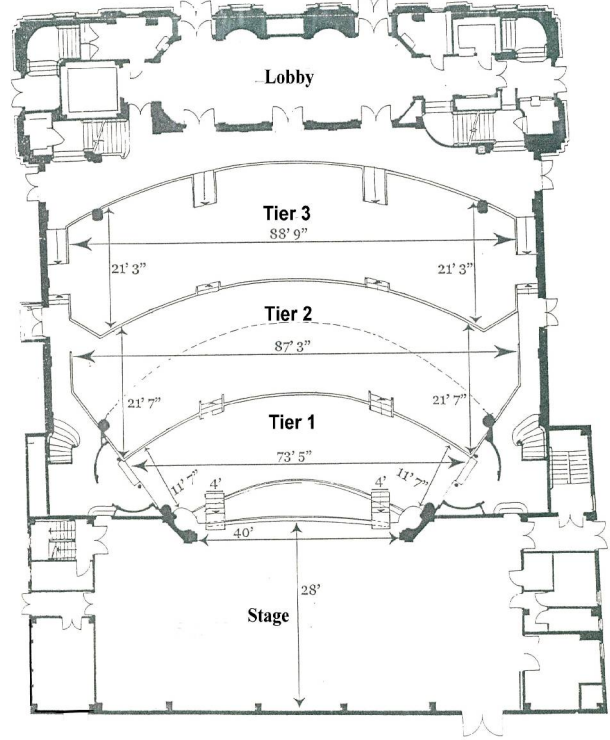
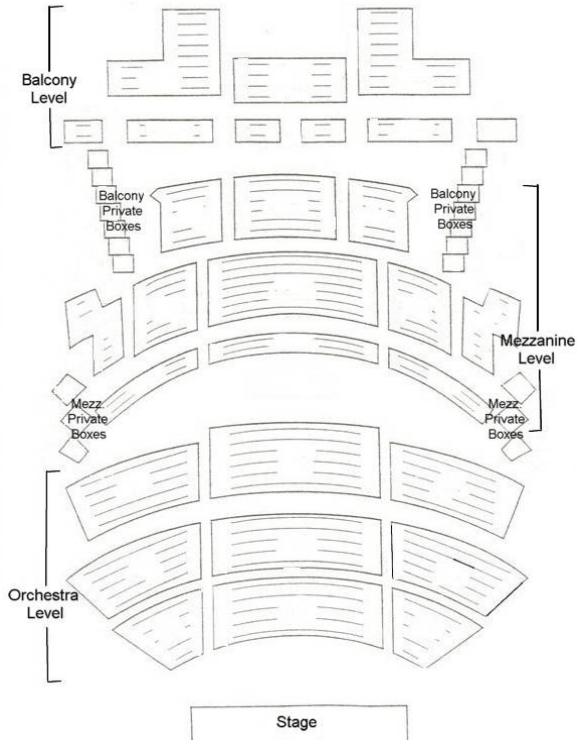

The stage house is as follows:

